

# PROGRAMMABLE ROOM THERMOSTAT

Model: TRB-1000ALNK

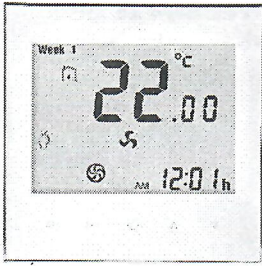

Alpine white

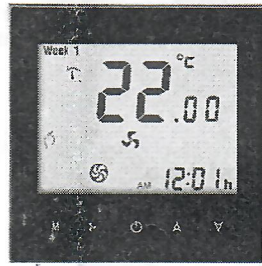

Ultra black

## In the box

- Thermostat: 1 pcs
- Wall Plate: 1 pcs
- Screws: 2 pcs
- User Guide: 1 pcs

## Warranty

Company offers a 2-year warranty on the thermostat, starting with the date of the purchase. A claim must include a detailed report on the fault. If it is not a problem of quality or if the claim is filed after end of the warranty time, we can charge for the after-sale service.

## Technical specifications

- Sensor: NTC
- Accuracy:  $\pm 1^{\circ}\text{C}$
- Temperature range: 5 - 35°C
- Power consumption: <1.5W
- Timing error: <1%
- Power supply: 110-240V, 50-60Hz
- Current load: 1A Inductive, 2A Resistance
- Housing material: PC (Fireproof)
- Dimension: 86 x 86 x 13.3 mm
- Installation box: 86\*86 mm / European 60 mm
- Ambient temp.: 0 ~ 45°C, 5-95% RH (Non condensing)
- Storage temp: -5°C ~ +55°C
- K: Keycard contact
- 2-pipe, 2-wire or 3-wire

- Clock
- Backlight
- RS485/Modbus RTU communication

## Features

Sleek flat design with a thin chrome frame. Acrylic surface against scratches and fingerprints. Simple operation through capacitive touch buttons. Large screen with white backlight enables easy reading even in the dark. Four time-schedule programs for maximum comfort and energy efficiency. One touch control for resetting all schedule programs at any time. Precise comfort control with 1°C temperature setting steps. Data memory when power is off. Easy installation (86 mm box or European 60 mm round box optional).

## Display

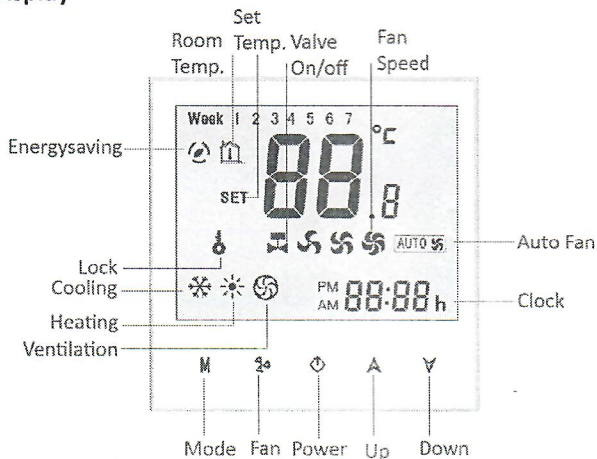

## Settings

### 1. Setting the temperature

In Manual mode, press touch buttons "Up/Down A V" to set the temperature. The "SET" icon will be displayed in the display.

### 2. Locking the display (optional function)

Press and hold both A V for 3 seconds to lock the display. The key-shaped "Lock" icon will appear on the display. Press and hold A V for 3 seconds again to unlock the display.

### 3. Setting the fan

Press the "Fan" touch button to select fan speed: OFF, AUTO, HIGH, MED, LOW.

### 4. Setting the System mode

Press M to change the system mode HEATING, COOLING and VENTILATION. In VENTILATION mode, the valve is off but the fan runs.

### 5. Setting the Clock

Press and hold M to set Clock; Press M to set the minutes of the time, press A V to adjust the relative values. Same setting for hour and week of the time. After that, all will be confirmed automatically.

### 6. Setting functions and options

During power off, press and hold M and touch buttons at the same time for 5 seconds to access system functions.

Then press M to change the different items.

Press A or V to set the relative values, press .

All the settings will confirm automatically when power is on.

No.	Function	Settings & Options	Default
1	Temp. Calibration	-9 to 9	-2
2	Fan Control	00: When room temp. reaches the setpoint, the fan will turn off. 01: When room temp. reaches the setpoint, the fan will turn to low speed.	00
3	Lock	00: All the buttons are locked except POWER 01: All the buttons are locked	00
4	Heating/Cooling	00: Cooling only 01: Heating/Cooling 02: Heating only	01
5	Min. Set Temp.	5-15°C	10
6	Max. Set Temp.	5-35°C	30
7	Display mode	00: Display both set temp. and room temp. 01: Display set temp. only	00
8	Energysaving Mode	00: Energysaving 01: Standby	00
9	Energysaving Temp.	10-20°C for heating	15
A	Energysaving Temp.	25-35°C for cooling	30
B	Deadzone Temp.	1-5°C	1
C	NONE		
D	Modbus IP address	0x00-0xFF	1

### Remark for energy saving mode:

Energysaving mode is activated with the keycard contact. When keycard contact is disconnected, energysaving mode is active and energysaving icon is displayed in display. With setting parameter 9 - Energysaving mode, 2 possible settings can be set:

00: Energysaving - when the keycard is pulled off, the thermostat will enter energysaving mode.

01: Standby - when keycard is pulled off, the thermostat turns off.

## Wiring the thermostat

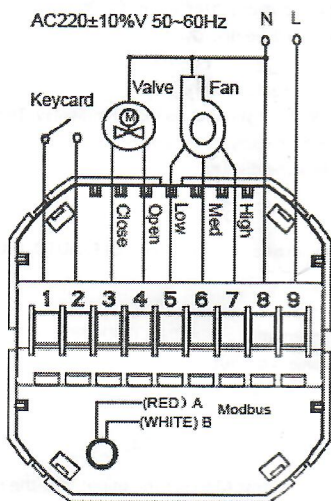

## Mounting the thermostat

This thermostat is suitable for a standard 86 mm wall box or a European 60 mm round box.

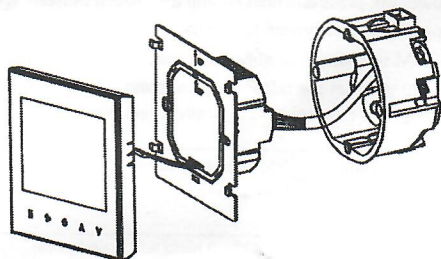

1. Connect the power wire and other equipment into the terminals.

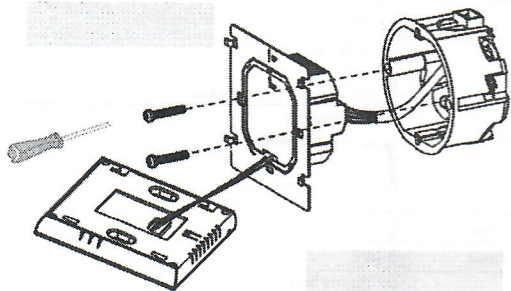

2. Fix the wall plate into the wall box with a screwdriver.

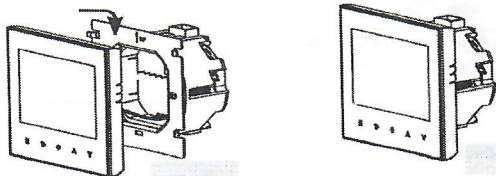

3. Slide the LCD board into the wall plate.

4. OK.

## Summary

A microprocessor based RS485 Room Thermostat with capacitive touch buttons and an LCD display. Designed to on/off control the fans and valves in air conditioning applications, comparing the room temperature and the set temperature, thereby achieving comfort while saving energy.



**WARNING:** Please arrange a professional technician to install this product according to installation

drawing and instruction.



**RISK OF ELECTRICAL SHOCK!** Disconnect power supply before making the electrical connection. Contact with components carrying hazardous voltage can cause electrical shock and may result in severe personal injury or death.

## Andivi d.o.o.

Zagrebska cesta 102  
Si – 2000 Maribor, SLOVENIA  
info@andivi.com  
[www.andivi.com](http://www.andivi.com)

**andivi**