

Datasheet

Issued: June 19, 2020

File Edition: A



Figure 1. Granite Display

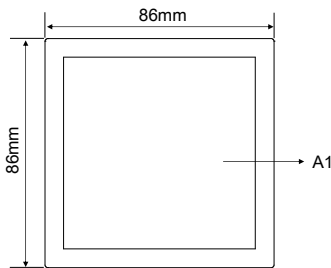

Figure 2. Dimensions - Front View

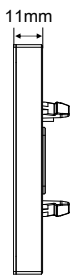

Figure 3. Dimensions - Side View

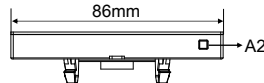

Figure 4. Dimensions - Side View

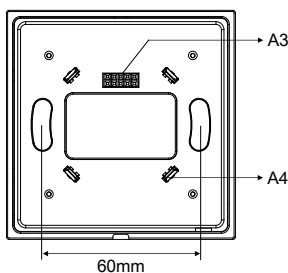

Figure 5. Dimensions - Back View

Overview

Granite Display (See Figure 1) is a high-end and multi-function control panel for home automation. With 4-inch LCD screen and full-screen touch control, it is convenient for the users to control lighting, curtain, scene, air conditioning, floor heating, music and fresh air in an intuitive way.

Its functions include:

- Built-in temperature and humidity sensor, proximity sensor
- Adjustable LCD backlight brightness
- LCD screen wakes up automatically
- Supports screen lock
- Supports sleep mode, the panel can be set to enter sleep mode if there is no operation for a certain period of time.
- 3 shortcut scene buttons, 4 function navigation buttons, and 1 main menu button available in main interface (All of which support local operation and configuration via HDL Buspro Setup Tool.)
- Time and environment status display and setting
- Dedicated pages for lighting, curtain, scene, air conditioning, floor heating, music and fresh air
- Up to 64 control buttons can be set in lighting page in total, with the control types of relays, dimmers, RGB lamp bands and CCT.
- Up to 8 curtain motors supported for curtain control (including motorized curtain, roller blind motor), with the control types of open/close, stop, percentage adjustment, swing angle control
- Scene control: Up to 32 scenes supported
- Air conditioning control: Up to 8 air conditioners supported, with the control types of on/off, temperature adjustment, fan speed adjustment, mode switching
- Floor heating control: Up to 8 floor heating modules supported, with floor heating modes of Normal, Day, Night, Away, Auto and control types of on/off, temperature adjustment, floor cooling and floor heating switch, mode switching
- Music play: Up to 8 music players supported
- Fresh air control: Up to 8 fresh air devices supported with the control types of on/off, fan speed, mode, etc.
- Buspro voltage detection supported
- Online update supported via HDL Buspro Setup Tool

Components and Operation

Dimensions - See Figure 2 - 5

A1. LCD screen: 4-inch touch screen

A2. Temperature and humidity sensor

A3. Communication interface: HDL Buspro bus connector for connecting to panel power interface.

A4. Mounting slot: Connects to panel power interface.

Proximity sensing: Also known as wake-up function, when the panel detects someone, the LCD screen will wake up automatically.

Installation

Installation - See Figure 6

Step 1. Install the wall box in the wall.

Step 2. Fix the power interface into the wall box with screws.

Step 3. Hold the edge of the panel, and insert the panel in the slots of power interface vertically.

Important Notes

- The panel must be wall box installation.
- The panel must work in conjunction with power interface.
- Buspro connection - Series connection. (hand-in-hand recommended)
- The panel should be connected to the switchboard for UI updating.

Safety Precautions

- The installation and commissioning of the device must be carried out by HDL or the organization designated by HDL. For planning and construction of electric installations, the relevant guidelines, regulations and standards of the respective country are to be considered.
- HDL does not take responsibility for all the consequences caused by installation and wire connection that are not in accordance with this document.
- Please do not privately disassemble the device or change components, otherwise it may cause mechanical failure, electric shock, fire or body injury.
- Please resort to our customer service department or designated agencies for maintenance service. The warranty is not applicable for the product fault caused by private disassembly.

Package Contents

HDL-MPTL4C.48*1 / Datasheet*1

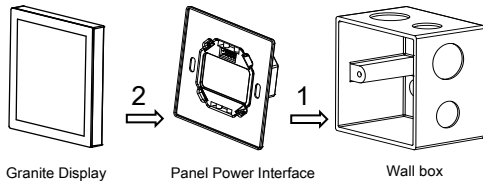

Figure 6. Installation

Technical Data

Basic Parameters

Working voltage	12~30V DC
Working current	120mA/24V DC
Communication	HDL Buspro
Cable diameter of Buspro terminal	0.6-0.8mm

External Environment

Working temperature	-5°C~45°C
Working relative humidity	≤90%
Storage temperature	-20°C~60°C
Storage relative humidity	≤93%

Specifications

LCD screen resolution	720x720
Dimensions	86×86×11 (mm)
Net weight	92g
Housing material	Glass, aluminum, PC
Installation	Wall box (See Figure 6)
Protection rating (Compliant with EN 60529)	IP20

Name and Content of Hazardous Substances in Products

Components	Hazardous substances					
	Lead (Pb)	Mercury (Hg)	Cadmium (Cd)	Chromium VI (Cr (VI))	Poly-brominated biphenyls (PBB)	Poly-brominated diphenyl ethers (PBDE)
Plastic	o	o	o	o	o	o
Hardware	o	o	o	o	-	-
Screw	o	o	o	x	-	-
Solder	x	o	o	o	-	-
PCB	x	o	o	o	o	o
IC	o	o	o	o	x	x
Glass	o	o	o	o	o	o

The symbol “-” indicates that the hazardous substance is not contained.

The symbol “o” indicates that the content of the hazardous substances in all the homogeneous materials of the component is below the limit requirement specified in the Standard IEC62321-2015.

The symbol “x” indicates that the content of the hazardous substance in at least one of the homogeneous materials of the part exceeds the limit requirement specified in the Standard IEC62321-2015.

HDL Buspro Cable Guide

HDL Buspro	HDL Buspro Cable
DATA+	Yellow
DATA-	White
COM	Black
24V DC	Red

Technical support

E-mail: hdtickets@hdlautomation.com
 Website: <https://www.hdlautomation.com>

©Copyright by HDL Automation Co., Ltd. All rights reserved.
 Specifications subject to change without notice.